

10 Elstow Gardens, Dagenham, RM9 6BA

Price Guide £350,000

- Three-bedroom terraced house
- Generous rear garden
- Convenient for local schools and shopping facilities
- Guide Price £350.000 - £370.000
- Ideal for buyers looking to modernise
- Close to Becontree Underground Station
- Quiet cul-de-sac location

10 Elstow Gardens, Dagenham RM9 6BA

Maybury Estates are delighted to offer for sale this three-bedroom terraced home, situated within a quiet residential cul-de-sac and offering well-proportioned accommodation with excellent potential for buyers looking to put their own stamp on a property.

The ground floor comprises a reception room, fitted kitchen and family bathroom, while the first floor offers three spacious bedrooms. To the rear, the property benefits from a generous garden with scope to extend, subject to the necessary planning permissions and building regulations.

Conveniently located for everyday amenities, the property is within easy reach of local schools, shopping facilities and transport links, making it an ideal purchase for first-time buyers, families or investors alike.



Council Tax Band: C



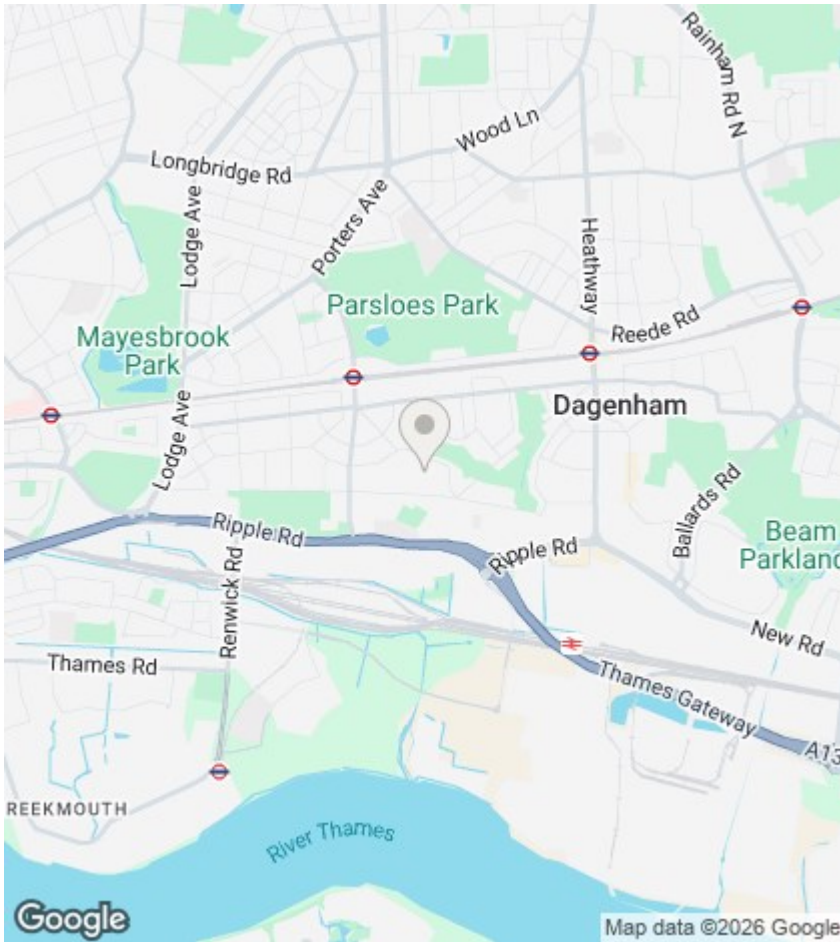

Directions

Viewings

Viewings by arrangement only. Call 0207 018 0660 to make an appointment.

EPC Rating:

D

Energy Efficiency Rating		Current	Potential
Very energy efficient - lower running costs			
(92 plus) A			
(81-91) B			
(69-80) C			
(55-68) D		67	
(39-54) E			
(21-38) F			
(1-20) G			
Not energy efficient - higher running costs			
England & Wales		EU Directive 2002/91/EC	

GROUND FLOOR
390 sq ft. (35.8 sq.m.) approx.

1ST FLOOR
374 sq ft. (34.8 sq.m.) approx.

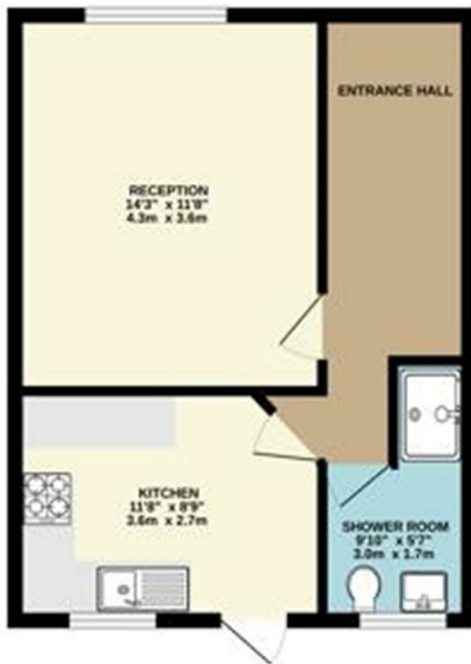

TOTAL FLOOR AREA: 770 sq ft. (71.5 sq.m.) approx.

Whilst every attempt has been made to ensure the accuracy of the floorplan contained herein, measurements of doors, windows, rooms and any other items are approximate and no responsibility is taken for any error.